

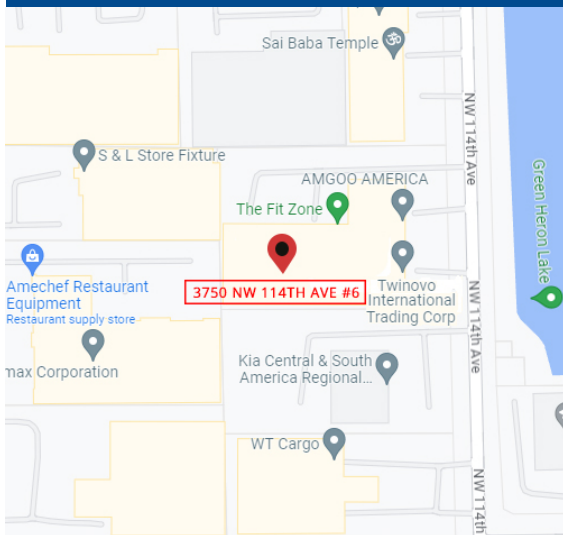

INDUSTRIAL SPACE FOR SUBLEASE +/- 6,100 SF



PROPERTY FEATURES

- +/- 6,100 SF Total Space
- +/- 5,100 SF warehouse
- +/- 1,000 SF Offices on 2 levels
- 22' Ceiling height
- 2 Docks (Double Wide Door)
- Twin-T Concrete Roof
- LED lighting
- Ample Parking
- Lease expires May 31, 2024

For More Information Contact:

Elias G. Patsalos, CCIM

Phone: 305-804-9154

Email: elias@agorare.com

Michal Bibr

Phone: 305-458-4140

Email: michal@agorare.com

SUBLEASE RATE

15.40 PSF GROSS

Agora Real Estate Group

7500 NW 25th Street, Suite 237, Doral, FL-33122

P: +1 (305) 804-9154 | F: +1 (866) 708-2763 | E: info@agorare.com

No warranty or representation, expressed or implied, is made as to the accuracy of the information contained herein, and same is submitted subject to errors and omissions.

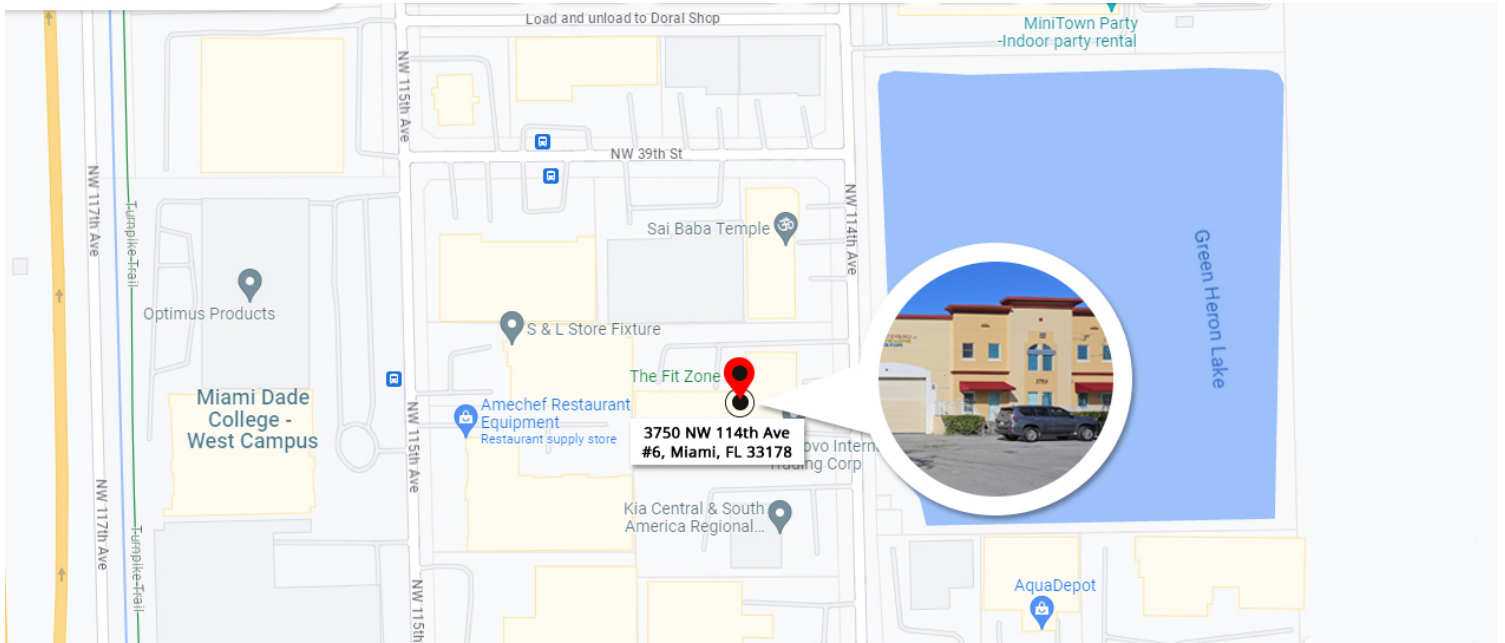

PROPERTY PICTURES

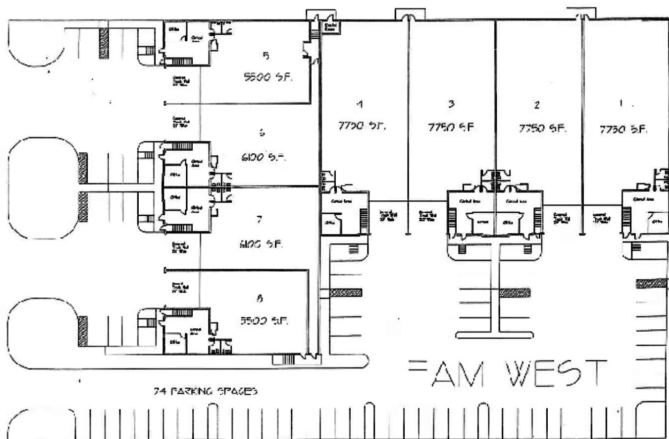

Agora Real Estate Group

7500 NW 25th Street, Suite 237, Doral, FL-33122

P: +1 (305) 804-9154 | F: +1 (866) 708-2763 | E: info@agorare.com

No warranty or representation, expressed or implied, is made as to the accuracy of the information contained herein, and same is submitted subject to errors and omissions.